

PIANO TERRA

VILLA - L

Sup. Lorda Villa = 64.65 + 66.28 = 130.93mq

Sup. Lorda Box = 40.98mq

Sup. Terrazzo = 56.38mq

Sup. Giardino di Pertinenza = 77.03 + 125.19 = 202.22mq

Giardino L 1
77.03 mq

AUI

AUI

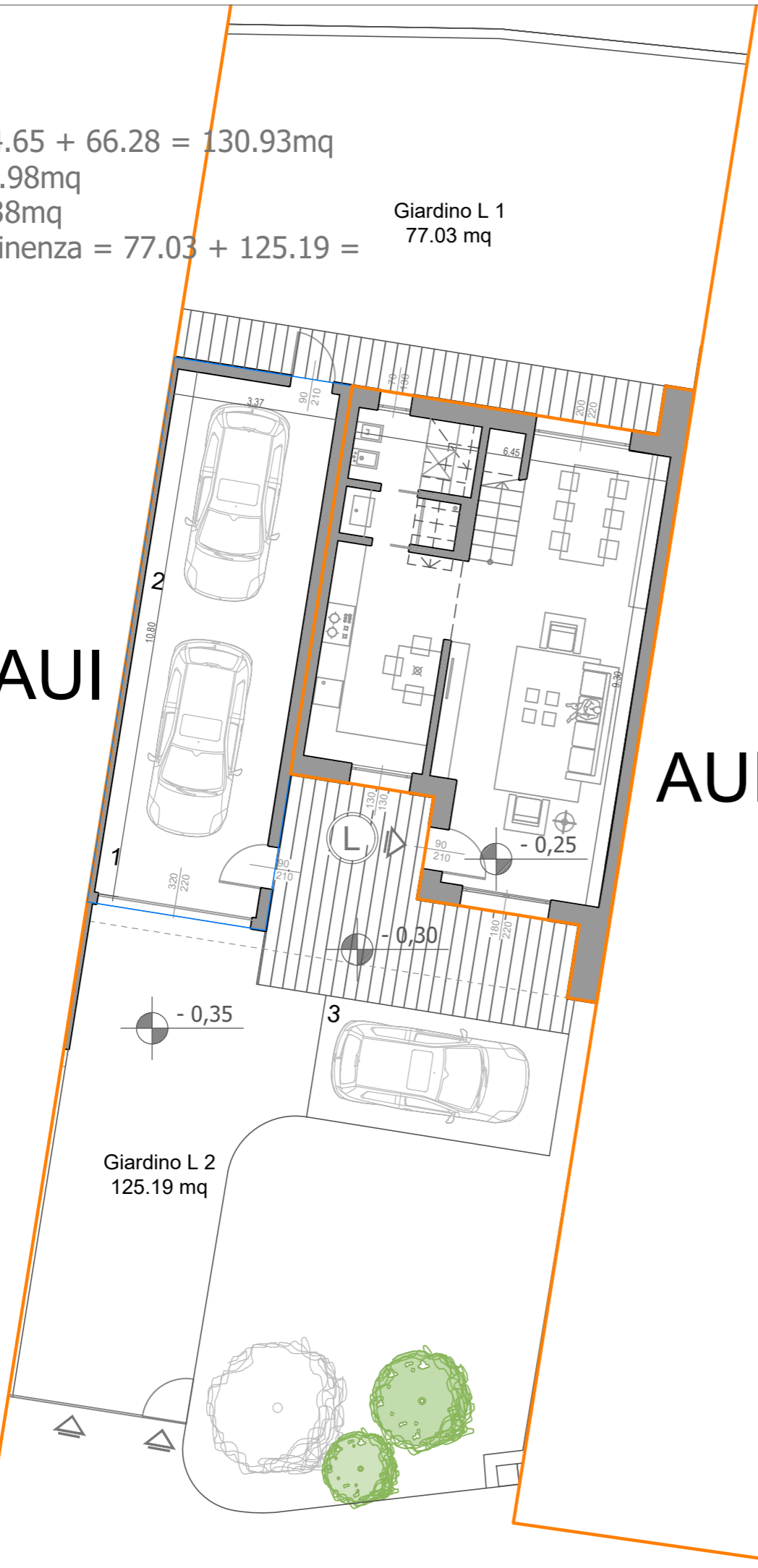

PIANO PRIMO

AUI

AUI

