

PIANO TERRA

PIANO PRIMO

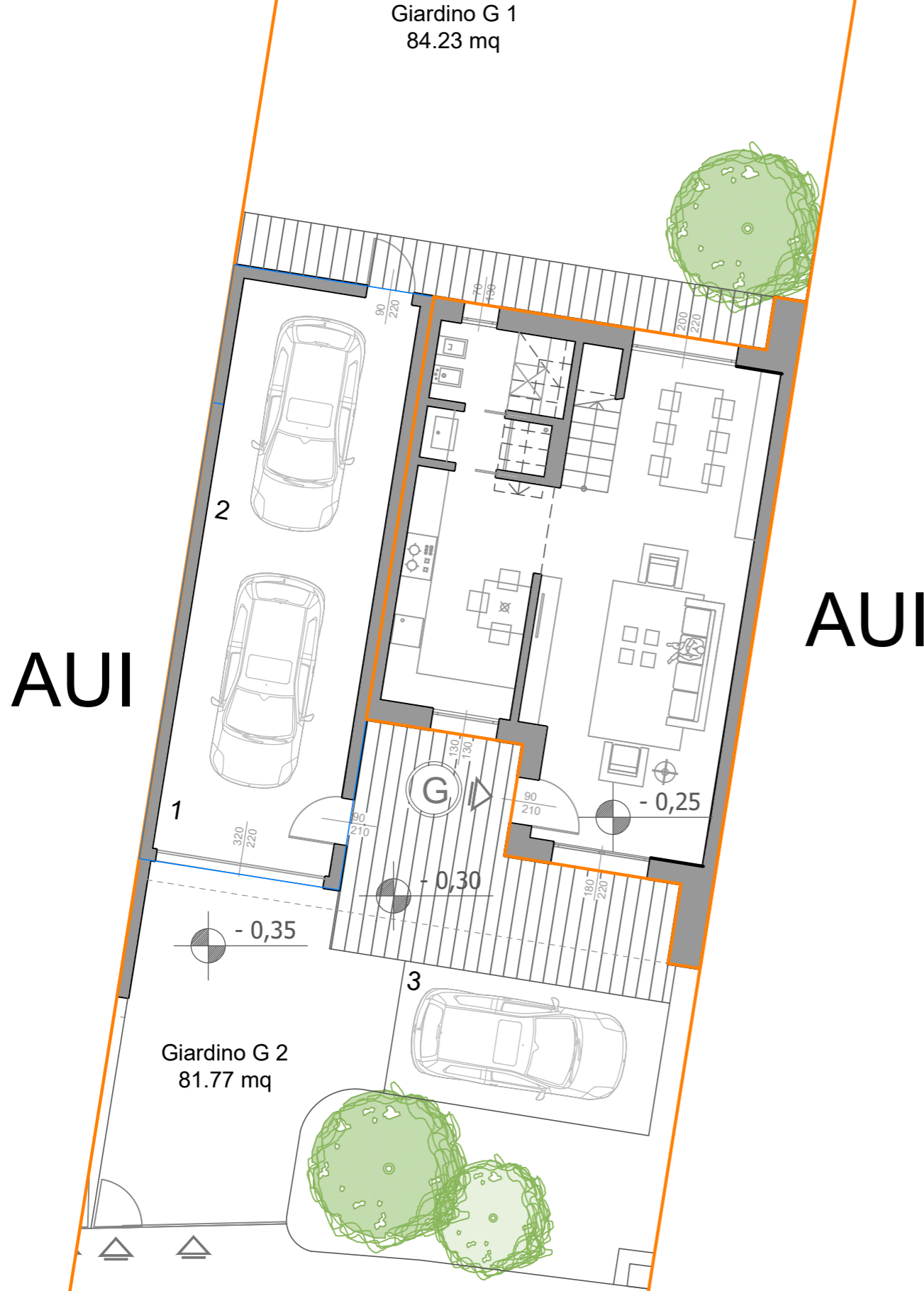

VILLA - G
 Sup. Lorda Villa = 64.65 + 65.53 = 130.18mq
 Sup. Lorda Box = 42.25mq

Sup. Terrazzo = 57.43mq
 Sup. Giardino di Pertinenza = 81.77 + 84.23 = 166.00mq