

PIANO TERRA

PIANO PRIMO

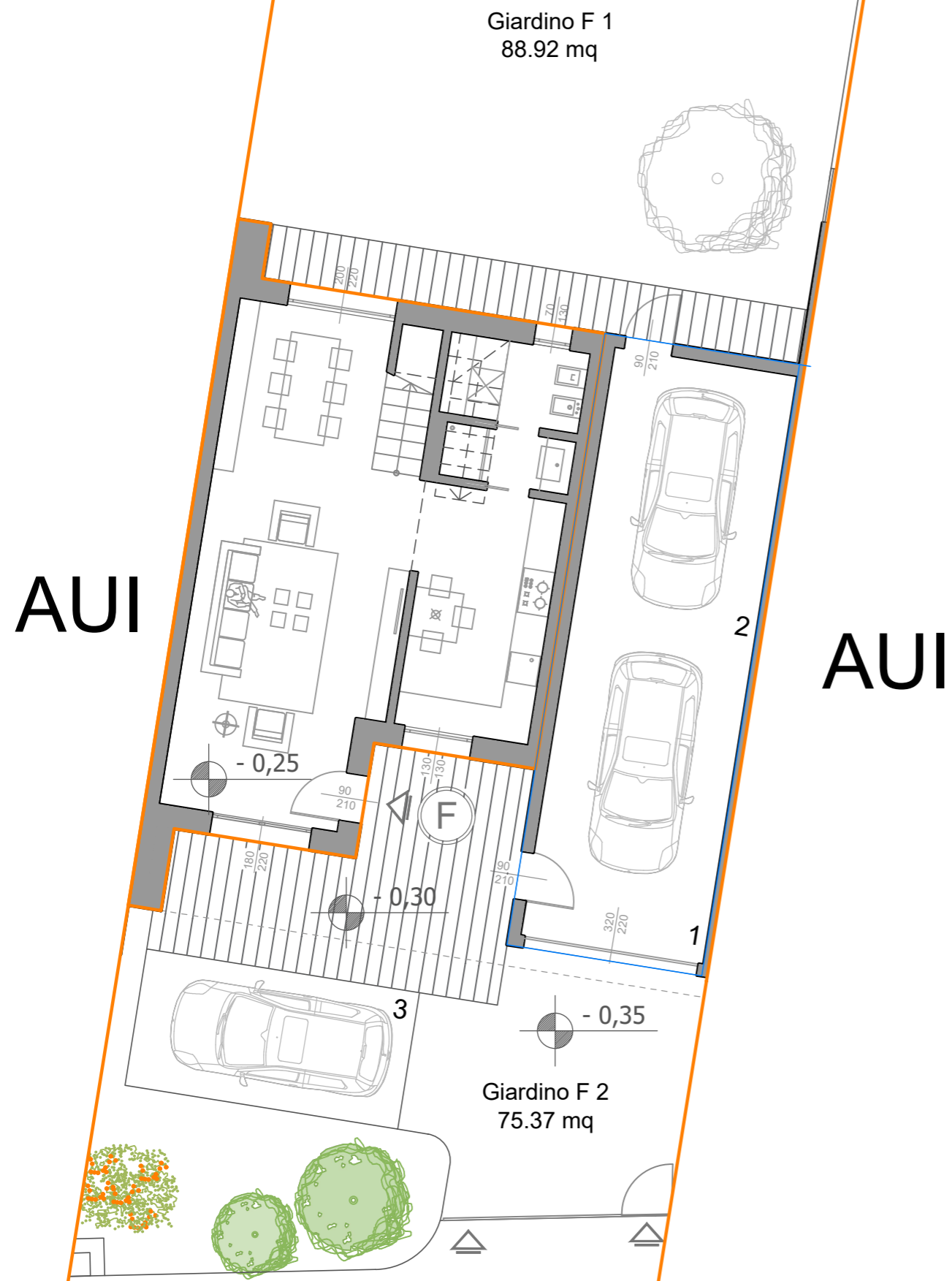

VILLA - F
 Sup. Lorda Villa = 64.65 + 65.53 = 130.18mq
 Sup. Lordo Box = 39.97mq

Sup. Terrazzo = 57.24mq
 Sup. Giardino di Pertinenza = 75.37 + 88.92 = 164.29mq